

DDE EB1200RD (art. EB1200RD)

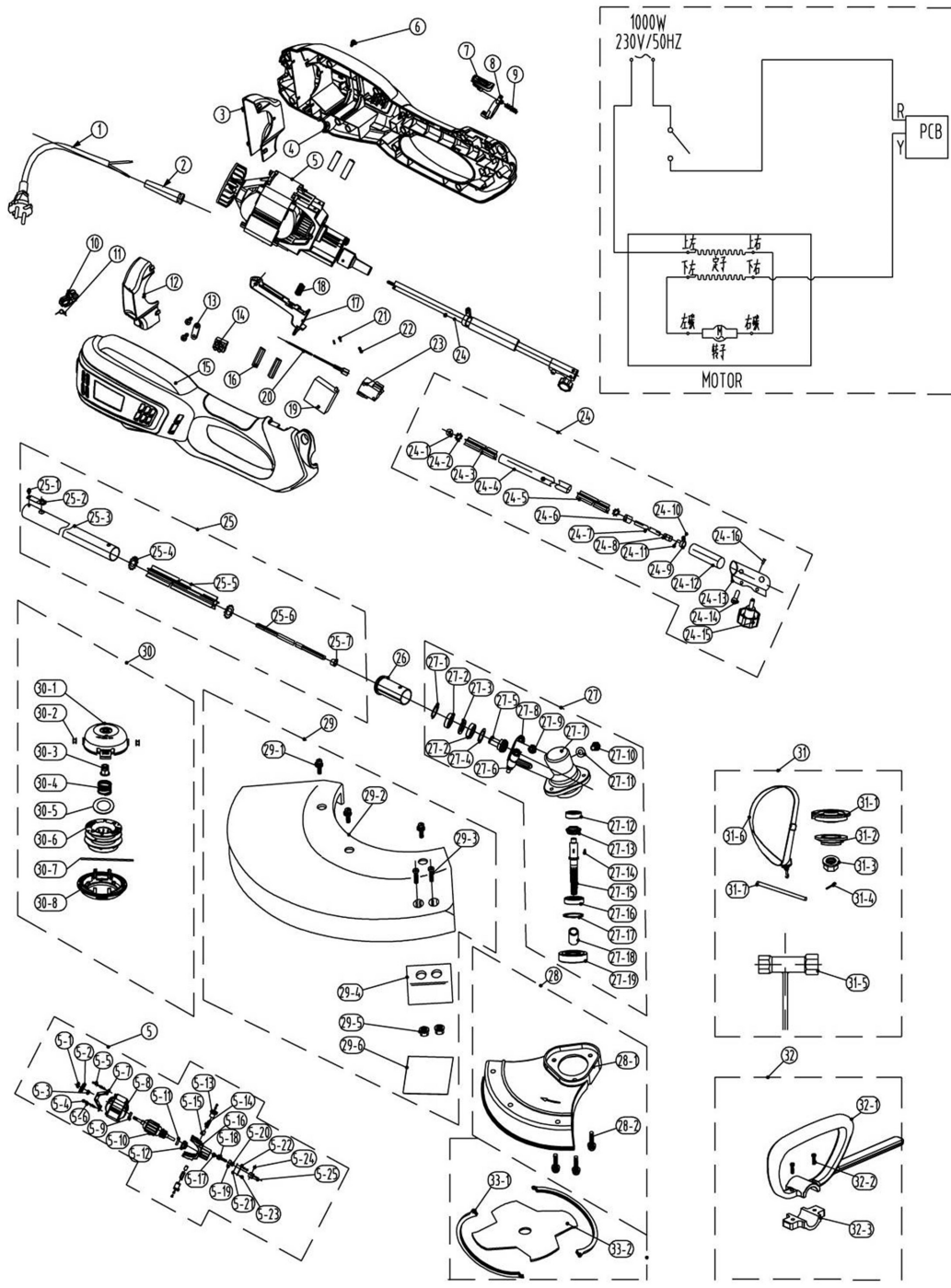

NoNo	Manufacturer Part Number	Part Name	Quantity
1	PR8422-625205	Cable/Plug	1
2	DPR8332-532101-01	Cable sleeve	1
3	PR8004-690501SB	wind scooper	1
4	PR8006-690591Kd	Left housing	1
5	PR8440-690529	'Motor assy'	1
5-1	R8CE-07B	Split washer	1
5-2	PR8403-692201WA	Fan blade	1
5-3	R8334-692203	Spindle cover	1
5-4	R8206-481001	Stator screw	2
5-5	R8324-481001	Spring washer	2
5-6	R8321-481002	Flat gasket	2
5-7	R8292-692202	Rear support	1
5-8	PR8405-692202	'Stator assy'	1
5-9	RBC-220807-ST	608 Bearing	1
5-10	PR8402-692202	'Rotor assy'	1
5-11	RBC-221006-ST03	Bearing 6900z	1
5-12	PR8333-691501	Bearing sleeve	1
5-13	DPR8409-692201-01SB	Brush support	2
5-14	R8409-692204	Copper brush holder	2
5-15	R8406-692201	Carbon brush	2
5-16	R8292-692201-01	Front support	1
5-17	RBE-100608	Multi-roll bearing	1
5-18	R8081-692202	Gear shaft	1
5-19	R8BC-240808-ST	Bearing 628Z	1
5-20	R8334-692203	Spindle cover	1
5-21	R8186-692202	Base plate	1
5-22	R8186-692201	Clamp	1
5-23	R8SIGN04-12B	Combination screw	7
5-24	R9PB30-22B	Pin	1
5-25	PR8081-691504-01	Connector shaft	1
6	8SJAB40-16B	Self tapping screw 4*16	13
7	PR8312-692201SB	Push button	1
8	PR8204-692301-01SB	Limit sleeve	1
9	R8342-691302	Pressure spring	1
10	PR8343-692301SB	Hang line hook	1



DYNAMIC DRIVE EQUIPMENT

DDE EB1200RD (art.EB1200RD)

Technical department

Assembly drawing

Engineer, chief designer

John Emerson Jr.

DYNAMIC DRIVE EQUIPMENT, USA

Page 1

DDE EB1200RD (art. EB1200RD)

№№	Part Number	Part Name	Quantity
11	R8342-692301	Torsional spring	1
12	PR8004-690502SB	wind scooper	1
13	PR8184-282101WA	Cable clamp	1
14	PR8411-522201	Connector	2
15	PR8006-690502Kd	Right housing	1
16	DPR8341-692201	Rubber washer	4
17	PR8044-692301SB	Switch trigger	1
18	R8342-740201	Switch spring	1
19	PR8414-690501	Soft start	1
20	PR8415-690502	Connecting wire	1
21	R8D-C15-3282	Tooth profile terminal	2
22	R8D-L51-4815	Mother terminal	1
23	PR8042-690501	Switch	1
24	R8440-690508SB	Rear connector tube assy'	1
24-1	R9325-903102	Fixing plate	1
24-2	R8201-691101	Retaining ring	2
24-3	PR8061-691206SB	Limit sleeve tube	1
24-4	R8440-690508SB	Rear connector tube assy'	1
24-5	PR8061-690501SB	Limit sleeve tube 1	1
24-6	R8204-691201	Iron hoop	1
24-7	R8089-690501	Soft shaft	1
24-8	R8065-691201	Connector joint	1
24-9	R9204-691502D	Braces ring	1
24-10	R8NG-05D	Self-locking nut	1
24-11	R8SJGD05-08D	screw	1
24-12	PR8331-691502	Handle sleeve	1
24-13	R8440-691202-02	Connector tie	1
24-14	R8SACD06-12B	Inner-hexagon screw	1
24-15	PR8313-691501SB	Knob	1
24-16	R8RJ04-06D	Pumping iron core rivet	1
25	R8440-690509SB	Front tube assembly	1
25-1	R8RB03-03N	Revit	1
25-2	R8324-692201	Reed	1
25-3	R8087-690501SB	Front tube assembly	1
25-4	R8201-691101	Retaining ring	2
25-5	PR8061-690502SB	Limit sleeve tube	1
25-6	R8089-690502	Front tube soft shaft	1
25-7	R8281-691508	shaft clip	1
26	R8065-691201	Connector joint	1
27	PR8440-692249	Gearbox components	1
27-1	8CA-22B	Retaining ring	1
27-2	9BB-221006-ST03	Bearing	2
27-3	9202-903102	Washer	1
27-4	9CD-10B	C retainer ring	1
27-5	9123-903102	Helical gear	1

№№	Part Number	Part Name	Quantity
27-6	8NG-05D	Self-locking nut	2
27-7	9146-903101U	Gearbox	1
27-8	85FHN05-30D	Sectional hub	2
27-9	85FHN05-12D	Sectional hub	1
27-10	95FDD08-10D	Outer hex screw	1
27-11	8208-903101	Airproof mat	1
27-12	9BB-260908-ST03	Bearing	1
27-13	9123-903101	Bevel gear	1
27-14	9205-903101	Woodruff key	1
27-15	9085-903101	Output shaft	1
27-16	9BB-321509-ST03	Bearing	1
27-17	8CA-32B	Jump ring	1
27-18	R8334-692203	Spindle cover	1
27-19	9200-903101	Oil seal	1
28	PR8440-903116	Small plastic cover components	1
28-1	PR8185-903104-03SB	Small plastic cover	1
28-2	8SJGN05-12B	Combination screw	3
29	PR8440-690510SB	Outside the shield	1
29-1	R8206-903101-01	Complex screw	3
29-2	PR8185-691504SB	Shield	1
29-3	R8SJGD05-14B	screw	2
29-4	R9231-923101	Blade	1
29-5	R8NG-05D	Self-locking nut	1
29-6	R8462-691501	Blade cover	1
30	PR8440-690525SB	Cutting head assy	1
30-1	PR8024-690502SB	Cutting head base	1
30-2	R8212-901301	Cutting head Eye	1
30-3	R8207-901301	Cutting head Nut	2
30-4	R8342-901301	Cutting head Spring	1
30-5	R8341-410201	Gear pad	1
30-6	DPR8121-690501SB	The winding body	1
30-7	PR9370-923101	Nylon wire	1
30-8	PR8024-690501SB	Cutting head upper cover	1

№№	Manufacturer Part Number	Part Name	Quantity
31	8440-692217	Accessories package	1
31-1	R9204-903101	shaft ring	1
31-2	R9186-903102	Blade pressboard	1
31-3	R8NG-10DL	Hexagon nut	1
31-4	R9PA14-20D	Cotter pin	1
31-5	R9261-903101D	Trigger	1
31-6	R9442-903101	belt	1
31-7	R8441-691501	Round rod	1
32	R9440-923145	P handle ass'y	1
32-1	PR9003-923107-02SB	P handle ass'y	1
32-2	R8SJAY05-20B	Lost the screw	2
32-3	PR9186-923102-01SB	Lower fixing plate	1
33-1	PR9454-903104	Blade cover	2



DYNAMIC DRIVE EQUIPMENT

DDE EB1200RD (art.EB1200RD)

Technical department

Assembly drawing

Engineer, chief designer

John Emerson Jr.

DYNAMIC DRIVE EQUIPMENT, USA

Page 2