

SSP12-80(12V80AH/20HR)

Спецификация

| | | |
|---|--|------------------------------|
| Вольтаж | 12V | |
| Емкость (20hr) | 80AH | |
| Габариты | Длина | 260±2mm(10.24inch) |
| | Ширина | 167±2mm(6.57inch) |
| | Высота | 213±2mm(8.39inch) |
| | Высота с клеммами | 216±2mm(8.50inch) |
| Вес | Approx. 21.0kg(+/-5%) | |
| Тип клемм | B4 | |
| Материал корпуса | ABS(UL-94HB) | |
| Внутреннее сопротивление | Approx.6.6mΩ | |
| Емкость (20hr) | 80.0Ah | (20hr, 1.75V/cell,25°C/77°F) |
| | 71.0Ah | (10hr, 1.75V/cell,25°C/77°F) |
| | 65.0Ah | (5hr, 1.75V/cell,25°C/77°F) |
| | 58.0Ah | (3hr, 1.75V/cell,25°C/77°F) |
| | 48.0Ah | (1hr, 1.75V/cell,25°C/77°F) |
| Максимальный разрядный ток | 900A(5S) | |
| Номинальная рабочая температура | 25±3°C (77±5°F) | |
| Циклический режим | Charge Current Less Than 0.25CA | |
| | 14.1V~14.7V@25°C(77°F)Temp. Coefficient -30mV/°C | |
| Буферный режим | 13.5V~13.8V@25°C(77°F)Temp. Coefficient -20mV/°C | |
| Емкость АКБ в зависимости от температуры окружающей среды | 40°C | 103% |
| | 25°C | 100% |
| | 0°C | 86% |
| | -15°C | 65% |
| Уровень саморазряда | 3 month | Remaining capacity: 91% |
| | 6 month | Remaining capacity: 82% |
| | 12month | Remaining capacity: 65% |

Terminal Type

■ Terminal T11

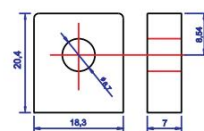

M6 Bolt & Nut

■ Terminal B4

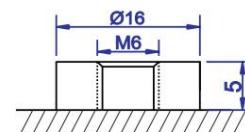

M6 Bolt

Разряд постоянным током А 25°C(77°F)

| F.V/Time | 5min | 10min | 15min | 30min | 1h | 2h | 3h | 4h | 5h | 6h | 10h | 20h |
|------------|------|-------|-------|-------|------|------|------|------|------|------|------|------|
| 1.80V/cell | 234 | 201 | 179 | 132 | 76,3 | 46,4 | 32,4 | 24,7 | 20,2 | 17,6 | 12,5 | 7,48 |
| 1.75V/cell | 264 | 229 | 196 | 136 | 77,4 | 47,5 | 33,0 | 25,0 | 20,7 | 17,9 | 12,7 | 7,50 |
| 1.70V/cell | 295 | 247 | 211 | 139 | 79,6 | 48,5 | 33,7 | 25,8 | 21,2 | 18,1 | 12,8 | 7,52 |
| 1.67V/cell | 314 | 253 | 215 | 141 | 81,8 | 49,1 | 34,3 | 26,3 | 21,6 | 18,4 | 12,9 | 7,53 |
| 1.60V/cell | 320 | 257 | 217 | 142 | 83,7 | 50,1 | 34,5 | 26,8 | 22,1 | 18,5 | 13,0 | 7,54 |

Разряд постоянной мощностью Вт/Эл 25°C(77°F)

| F.V/Time | 5min | 10min | 15min | 30min | 1h | 2h | 3h | 4h | 5h | 6h | 10h | 20h |
|------------|------|-------|-------|-------|------|------|------|------|------|------|------|------|
| 1.80V/cell | 160 | 120 | 96 | 69,8 | 39,8 | 24,9 | 18,5 | 14,2 | 11,8 | 10,6 | 6,98 | 3,52 |
| 1.75V/cell | 178 | 138 | 102 | 70,9 | 41,3 | 25,6 | 18,7 | 14,3 | 12,0 | 10,6 | 7,00 | 3,58 |
| 1.70V/cell | 183 | 141 | 110 | 72,5 | 42,0 | 26,2 | 19,0 | 14,3 | 12,3 | 10,7 | 7,02 | 3,59 |
| 1.67V/cell | 192 | 143 | 111 | 73,8 | 42,9 | 26,8 | 19,1 | 14,4 | 12,5 | 10,9 | 7,03 | 3,59 |
| 1.60V/cell | 194 | 144 | 113 | 75,0 | 43,5 | 27,5 | 19,3 | 14,6 | 12,6 | 10,9 | 7,04 | 3,60 |

Discharge Characteristics

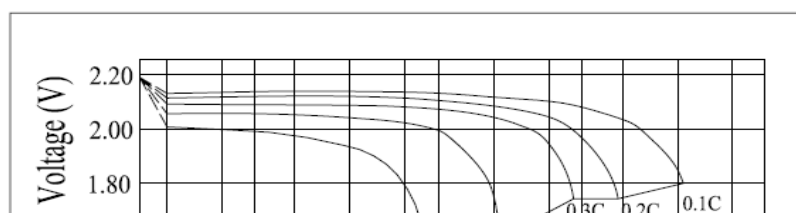

Float Charging Characteristics

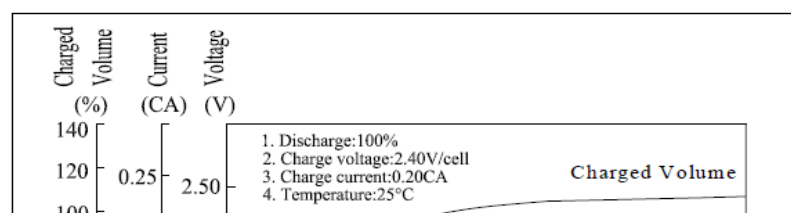

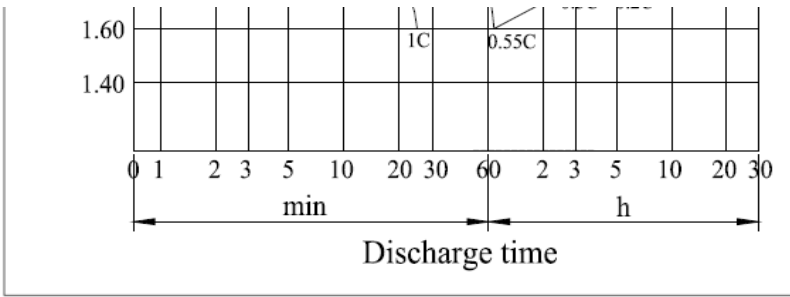

Floating Life on Temperature

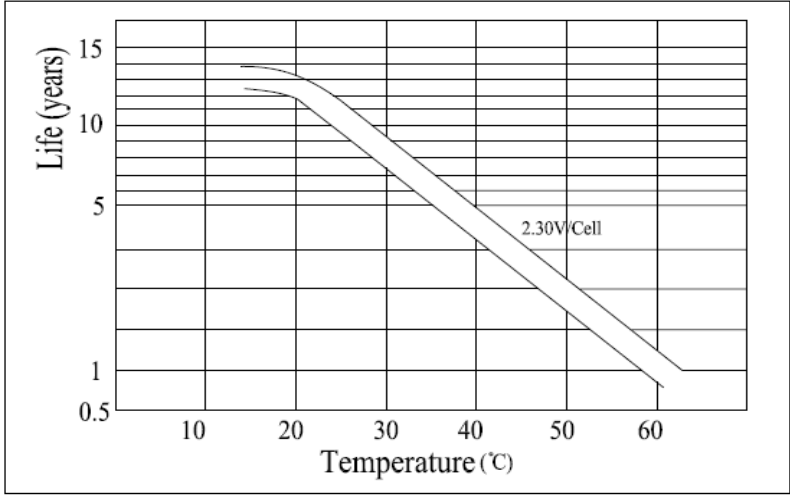

Temperature Effects in Relation to Battery Capacity

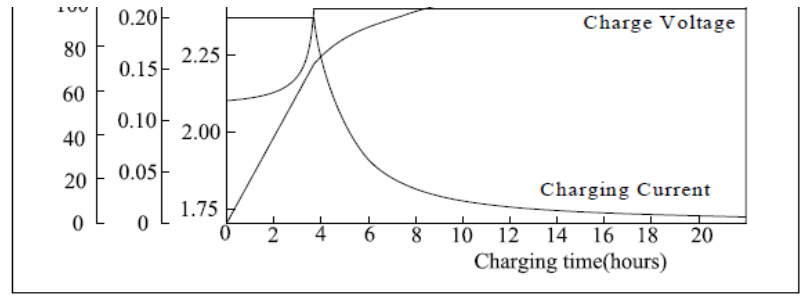
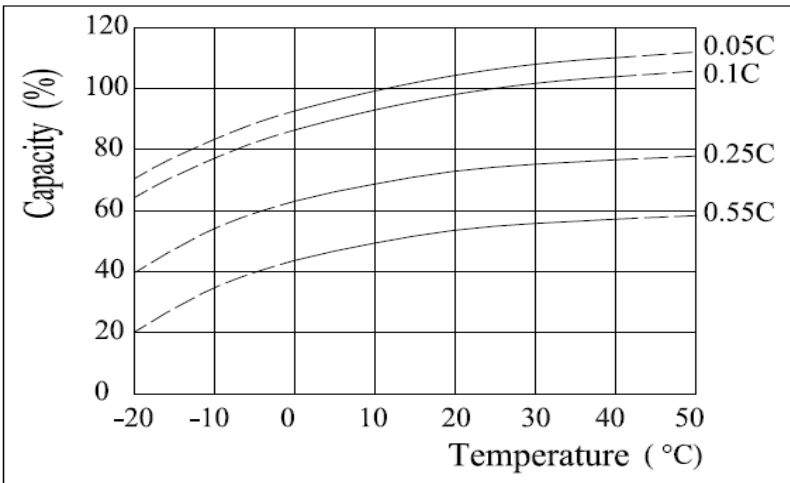

Self Discharge Characteristics (25°C(77°F))

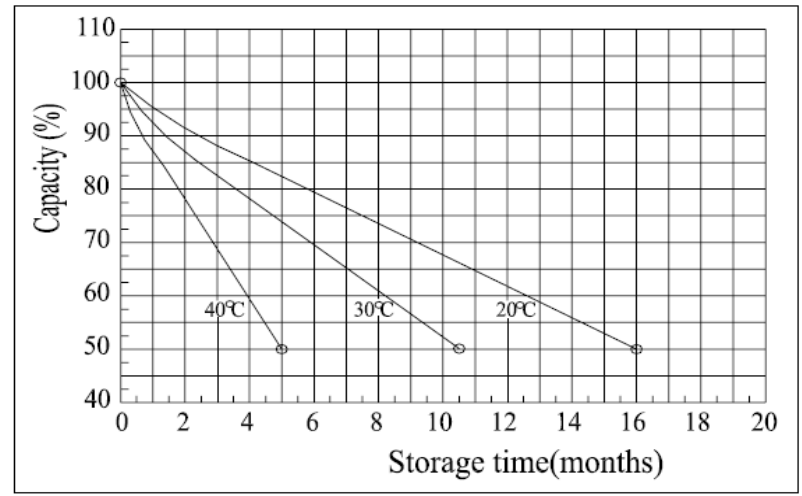

Cycle Life Relation to Depth of Discharge

