



Care and use instructions

CAUTION

- Product is NOT designed for hot liquids. Use only with cold liquids.
- Not for use with carbonated or pulpy beverages.
- Prior to drinking, make sure the lid is properly threaded to the body and screwed on completely.
- Avoid accidental depressing of the AUTOSPOUT® button by keeping the button free and clear of other objects.
- DO NOT overfill. Fill liquids to just below the threading in the body.
- DO NOT microwave or freeze.
- DO NOT use cleaners containing bleach, chlorine, abrasives and/or other harsh chemicals.
- DO NOT continue to use product if damaged.
- DO NOT carry bottles containing liquid in bags to help prevent accidental opening.

USAGE RECOMMENDATIONS



- Do not pull or rotate the spout shield as it may cause damage to the lid.
- Silicone drink spout is NOT removable.
- The AUTOSPOUT® lid that came with your new purchase is designed to only fit your Contigo® water bottle. Not for use with other products.

CLEANING INSTRUCTIONS

- Wash thoroughly before first use.
- RINSE IMMEDIATELY AFTER EACH USE with warm water and spout in the open position. Remove straw for best results.

Copyright © 2015 **contigo**, All rights reserved.

Kambukka bvba | Torenplein 7.16.1 | 3500 Hasselt | Belgium

contigo®

- Lid, plastic body and straw are top-rack dishwasher safe.

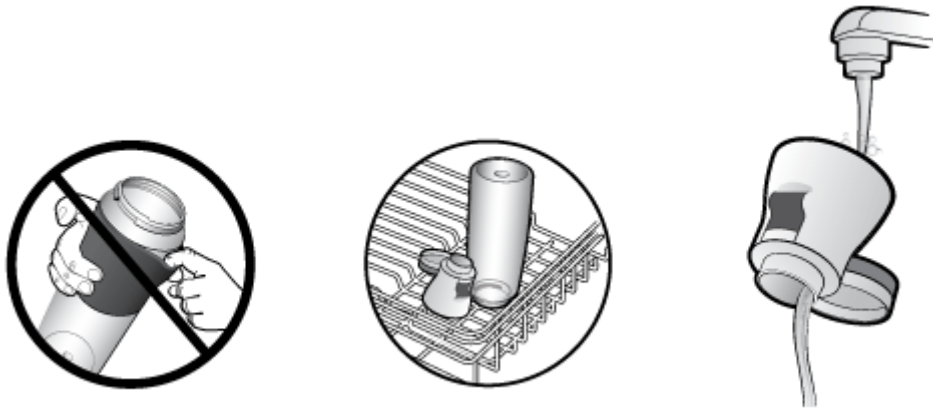

- If washing by hand, soak lid for 10 minutes in hot, soapy water. Hand wash body with warm water and a mild detergent. Rinse both lid and body thoroughly before use.
- ALWAYS STORE BOTTLE WITH LID REMOVED to allow parts to dry completely.

